



the arch

187 kings rd arches
brighton
bn1 1nb

info@thearch.club

venue_information_Feb23



Venue information



tickets ↗ www.thearch.club

CONTACTS

OFFICE TELEPHONE	+44 (0)1273 208 133
GENERAL & CUSTOMER ENQUIRIES	INFO@THEARCH.CLUB
LIVE PROGRAMMING	THEARCH@DIVERGENTVENUES.COM / 01243 963886
CLUB PROGRAMMING	DAMIEN@SLAPTHATSOUND.COM
VENUE MANAGER	JORDAN@THEARCH.CLUB
VENUE MARKETING	CARTER@SLAPTHATSOUND.COM

VENUE INFORMATION

GOOGLE MAPS LOCATION	https://goo.gl/maps/TmtPJ68j3EBVgMD77
CLUB CAPACITY	600
LIVE CAPACITY	450
OFFICE HOURS	MON-FRI 10:00-18:00
LIVE SHOW TIMINGS	DOORS 19:00 CURFEW 22:00
CLUB SHOW TIMINGS	DOORS 23:00 CURFEW 06:00

One of the south's most iconic spaces and leading event venues. Powered by the one of the UK's finest custom built Funktion One Soundsystems.

the arch
187 kings rd arches
brighton
bn1 1nb
info@thearch.club

Key
Contacts

tickets ↗ www.thearch.club

FRONT OF HOUSE**LOUDSPEAKER SYSTEM**

L&R Funktion One Dance Stack

Each consisting of

3 x f221 (double 21" bass bins)

1 x DS15 (single 15" low mid)

1 x DS210 (double 10" and 1.5" high freq)

STAGE IN-FILL:

2 x ElectroVoice EVID 6.2

POWERED BY:

1 x Soundcraft GU24R front end mixer

2 x F1 D6 digital speaker mgmt controller

3 x MC2 e45 amps running bass

1 x MC2 e25 low mid

1 x MC2 e25 high mid

1 x MC2 e15 high freq

1 x MC2 e15 Full range in-fill

DJ EQUIPMENT:

4x CDJ-2000nxs2

2x CDJ-2000nxs

2x Technics 1210mk5

1x Pioneer DJM 900nxs2

1x Pioneer DJM 900nxs

1x Pioneer DJM750mk2

DJ MONITORS

2 x Citronic Full Range

2 x Ohm 18inch Sub

LIVE SHOW FRONT OF HOUSE CONSOLE:

1 x Soundcraft Performer 3

1 x 32/8 channel Multicore

MONITORS

4 Way TQ-315 Monitors (4 Wedges + Sub)

2 x Turbosound LMS-D24.

2 x MC2 T1000

2 x MC2 E25

4 x Turbosound TQ-315

1 x Turbosound TQ-115DP

MICROPHONES, STANDS & CABLES

Shure Beta 52a

Shure Beta 91

Shure Beta 57a

Shure SM57

Shure Beta 58a

Shure SM58

Sennheiser E604

Audix ADX-51

AKG C214

BSS AR133 Active DI

Beyer-Dynamic GST500

Boom Mic Stand

Beyer-Dynamic GST500

Boom Mic Stand

30 x XLR Package

XLR 10m-15m

50 x XLR Package

XLR 10m-15m

HOUSE POWER:

Stage Right

6 x 13a Mains

1 x 16a mains

1 x 32a 3phase

Stage rear Centre

2 x 13a mains

Stage left

2 x 13a Mains

LIGHTING:

8 x Beam 200 moving heads (Clay Paky Sharpy clone)

11 x GLP volkslicht zoom RGB moving heads

4 x Chauvet rogue R2 LED spots

7 x RGBWA UV flat panel pars

8 x RGB Bricks

4 x LED ADJ Sweeper Beams (White)

Pangolin laser controller and FB3

2 x 2 watt RGB lasers at the stage

1 x 600mm rotating mirror ball

1 x Chauvet Hurricane Smoke Machine

LIGHTING CONSOLE

1 x ShowCad Artist3

Detail on request

VIDEO WALLS:

Over stage video wall

1 x 5x5panel P9 (2.97m x 2.97m) 320x320 pixels

DJ booth video wall

1 x 5x3panel P9 (2.97m x 1.78m) 320x192 pixels

MEDIA CONTROL

1 x ArKOAS MediaMaster 4 Server controlled over DMX

Recommended video size 480p in Windows format

Will not transcode from 4k

RIGGING:

Backdrop bar 8M long.

Recommended backdrop height

is 2.7m due to clearance of lighting truss.

DETAILED RIGGING & LX PLOTS, PATCH LISTS & VENUE DRAWINGS ARE
AVAILABLE AT REQUEST

Technical information

tickets ↗ www.thearch.club

the arch

187 kings rd arches
brighton
bn1 1nb

info@thearch.club

AGE RESTRICTIONS	Age Restriction: 14+ / Under 16's must be accompanied by 18+
PARKING	Due to seafront location, there is no parking at the venue. Please drop and go from top of ramp on Kings Road/A259. There are several pay and display car parks nearby and ample paid parking on Madeira Drive for larger vehicles.
BUSES:	Please let us know asap if you have a bus, we will attempt to park you at the Brighton Centre but this will not always be available. Powered parking is available out of town or unpowered on nearby Madeira Drive.
LOAD IN	Down ramp to venue entrance. Flat roll to stage
DRESSING ROOM	With private en-suite and shower – equip with large sofa, full length mirror, double fridge, kettle, toaster and production desk
WIFI	Production WIFI available throughout the building
ADDITIONAL SERVICES	
MERCHANDISE	We are able to provide a merch seller at a charge of £50 cash on the night. 0%/Zero % commission. All Divergent Venues are proud members of the FAC 100% scheme. hefac.org/venuedirectory/
BOX OFFICE	We are able to provide a member of box office staff at a charge of £15 + VAT per hour (min of 3 hours)
SOLUS MAILER	We can offer a solus mailer to targeted data for £50 + VAT
SHOW REP	If you require the venue to provide a show rep, please enquire for pricing
DISABLED ACCESS	Whilst we endeavour to promote full access to our facilities for all of our customers, this is an old building and our efforts are still a work in progress. Our live space is wheelchair friendly and customers with mobility issues will be offered priority viewing positions. We offer one free carer's pass per ticket holder. Carer ticket holders should be able to meet the needs and medical requirements of the person they are accompanying in the event of an emergency. Guide dogs welcome.

STAGE PLAN

All measurements are in metres

Stage Size	4m x 5.7m
Stage height:	0.7m
FOH position to stage	5m
Dance floor width:	10m
Dance floor length:	9.5m Dance
Ceiling Height	3.4m

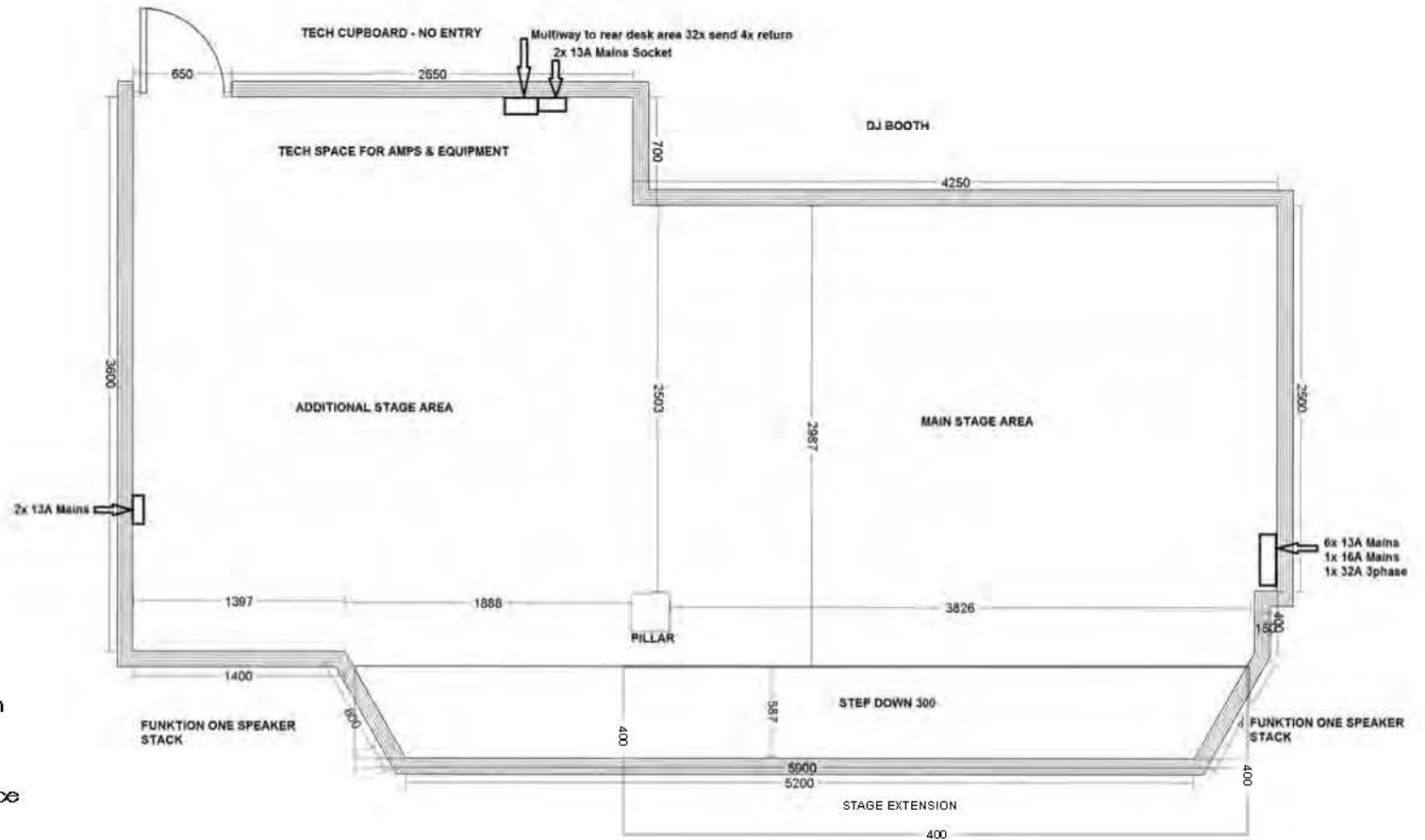

the arch
 187 kings rd arches
 brighton
 bn1 1nb
 info@thearch.club

Technical
 information

tickets ↗ www.thearch.club